

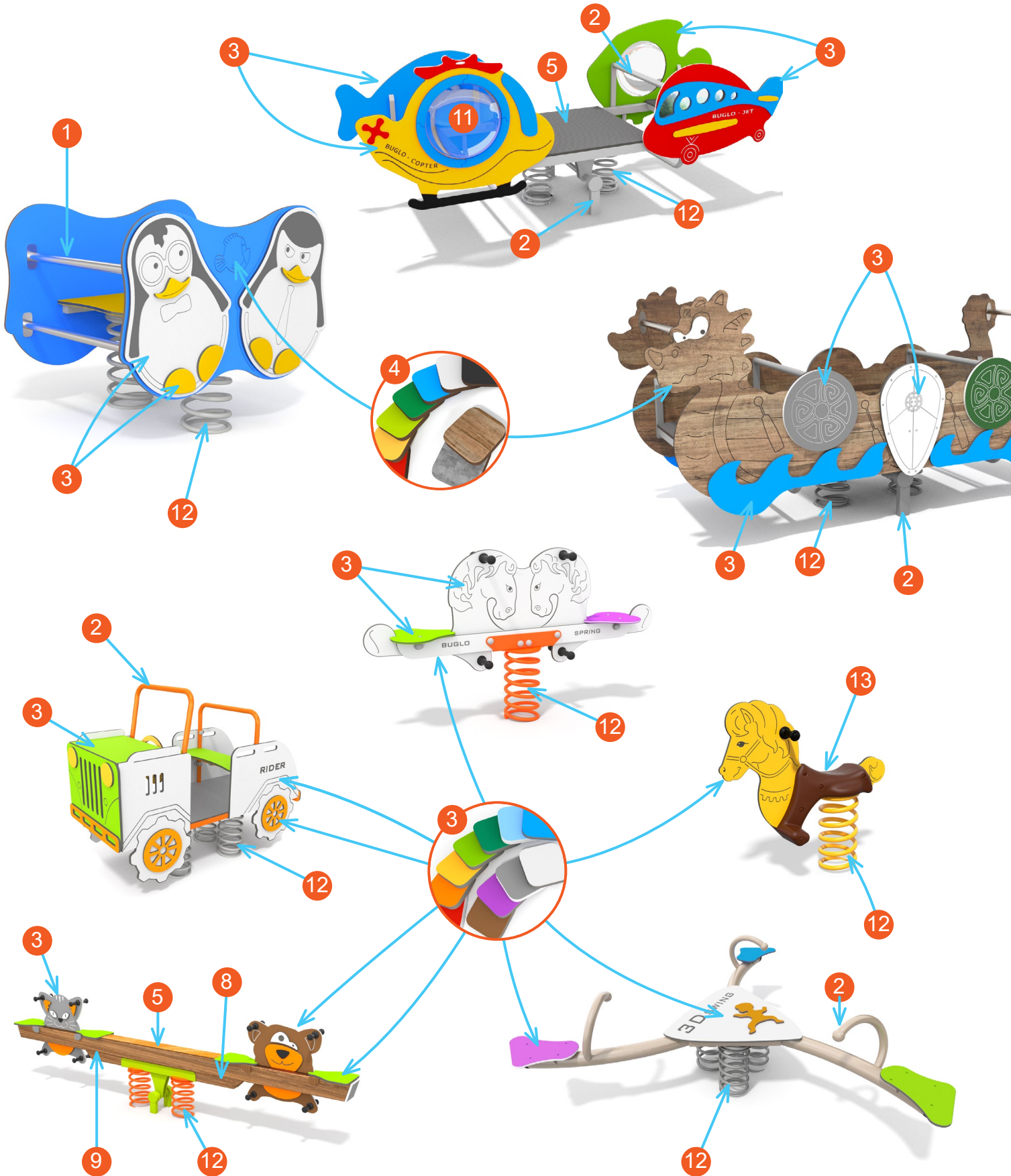

Buglo

Single Spring

MATERIAL SPECIFICATION



Let's play



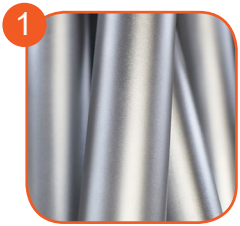
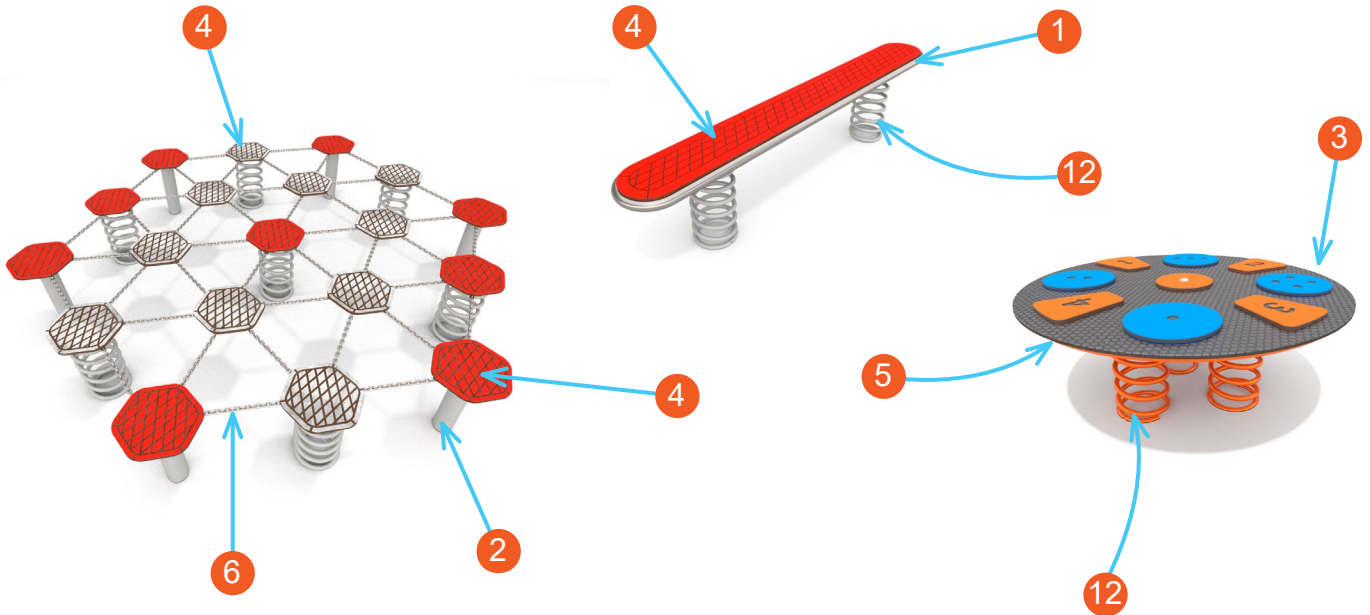

Solid construction made of stainless steel AISI 304 totally resistant to weather conditions.

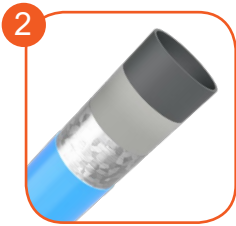

Solid construction made of black steel S235JR, cleaned in the sandblasting process. Protected against corrosion by galvanizing and powder coating with polyester paint QUALICOAT attested.



Plates of the walls made of colourful triple layered 15 mm HDPE polyethylene, in the highest quality, totally damp-proof and resistant to UV.



Plates of the walls and platforms made of colourful 13 mm HPL (black plates made of 8 mm HPL), in the highest quality, totally damp-proof and resistant to UV.



Anti-slip 10 mm HPL platform plate with a very high resistance to weather conditions and attrition.



Attested 6 mm stainless steel chains.



Handhold made of injection molded polyamide



Soft conifer wood 90 x 90 mm, coreless, glued in layers with polyurethane glues, totally resistant to water. Wood posts processed in three-phased impregnation process.



Soft conifer wood 140 x 140 mm, coreless, knotless, glued in layers with polyurethane glues, totally resistant to water. Wood posts processed in three-phased impregnation process.



Connecting elements like screws, nuts, washers made of stainless steel. Vandal-proof screw plugs made of injection molded polyamide.



Hemispheric window with a diameter of 400 mm. Material: heat - formed polycarbonate 5 mm thick.



Springers' springs made of spring steel. The diameter of the spring is 200 mm and the diameter of the rod is 20 mm. The springs and the fastenings are galvanized and powder coated with polyester paint, UV resistant and QUALICOAT attested. The fastenings are designed especially for solutions used on a playground, so they are stripped of elements which can cause danger to children.



Ergonomic seat made of injection molded polyamide.